

775,177M Rev. A
12/2005

Cat. No.	Model	Description
H1535	GEP-36BL	Glass Enclosure Panel, Black on Bronze
H1536	GEP-36PB	Glass Enclosure Panel, Brass on Bronze
H1537	GEP-36BS	Glass Enclosure Panel, Stainless on Bronze
H3430	GEP-33BL	Glass Enclosure Panel, Black on Bronze
H3433	GEP-33PB	Glass Enclosure Panel, Brass on Bronze
H3434	GEP-33BS	Glass Enclosure Panel, Stainless on Bronze

INSTALLATION INSTRUCTIONS FOR GLASS PANEL ENCLOSURE KITS FOR USE WITH MODELS MPE-33R AND MPE-36R ELECTRIC FIREPLACES

KIT CONTENTS:

1 ea. Glass Enclosure Panel
1 ea. Instructions Sheet

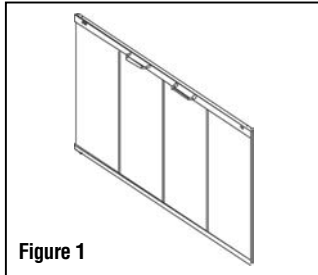

TOOLS REQUIRED:

None

INSTALLATION INSTRUCTIONS:

Ensure fireplace is cool to touch before starting installation.

Step 1. Remove the plastic protective coating from the trim surfaces of the glass enclosure panel.

Step 2. Locate the slots on the bottom side edges of the fireplace firebox opening and locate the tabs on the glass panel enclosure (see Figure 2). Insert the 2 tabs on the glass panel enclosure into the 2 corresponding slots on fireplace.

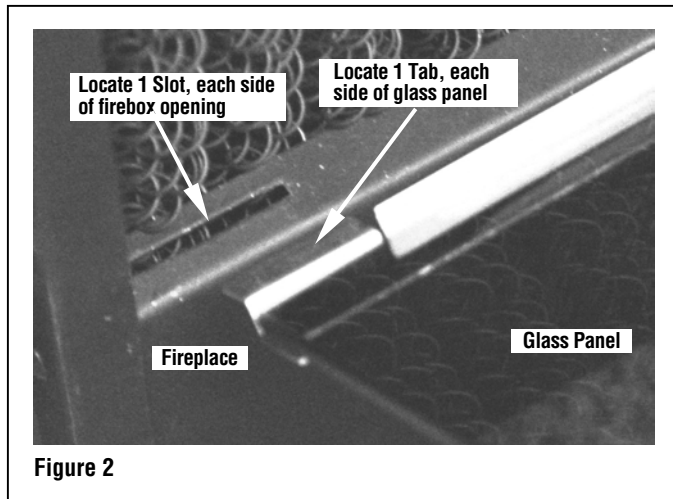

Step 3. Press the 2 latch buttons inward to retract locating pins (see Figure 3). Rotate the top of the glass enclosure panel back until it is flush with fireplace face. Release latch buttons, so pin retract and engage into corresponding holes on fireplace.

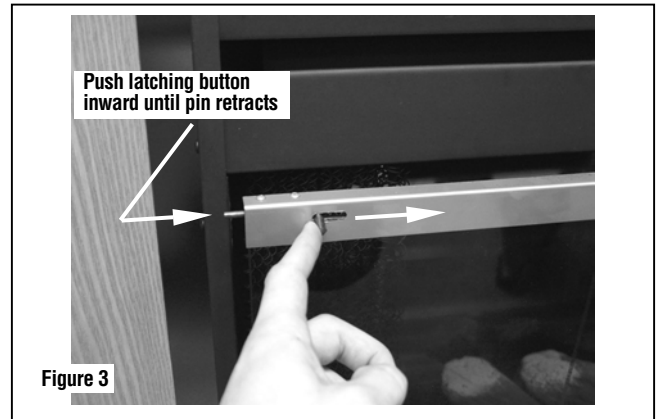

Cleaning - Never clean glass when hot. Do NOT use ammonia or ammonia based cleaners on glass or frame as it will damage the finish. Remove dirt and grime from glass using a clean dampened towel followed by wiping with a dry towel. To remove stubborn stains, use a mild soap solution and towel to gently scrub away stain. Take care not to scratch the glass surface. Do NOT use abrasive cleaners.

NOTE: DIAGRAMS & ILLUSTRATIONS NOT TO SCALE.

LENNOX reserves the right to make changes at any time, without notice, in design, materials, specifications, prices and also for discontinued colors, styles and products. Consult your local distributor for fireplace code information.